

Committee	COUNCIL MEETING
Date	15th October 2018
Agenda Item	12

Management of the trees in Holy Trinity and St Andrews churchyards

The trees in both churchyards have been pollarded many times over the years, and HTC originally planned to pollard them again. However, it has been pointed out that the trees are now very large, and there are probably too many of them in both churchyards. Further advice is being taken and those who have quoted are being asked to quote to cut down as well as to reduce the size of some trees.

Work required to trees in Holy Trinity churchyard

The Holy Trinity churchyard has become full of very large trees. Some of these are at risk of potentially falling on the church and causing damage, others are very close to walls supporting the churchyard, and their roots will disturb the wall. Others are self planted. The aim of the plan is to display the beautiful Gilbert Scott church to its full advantage for residents and visitors and to make the churchyard a safer place for the church and those passing by. The Tree Officer for BDC, Kieran McGrath, has now visited the churchyards, and has agreed the following:

1. Entering by the main entrance there is an avenue of very tall limes, marked as 10,11 and 12 on the sketch map. All of these should be reduced in height by 4/5 metres. The last one in group 11 nearest to the church should be felled as it is very close to the church.
2. Reduce the size of yews 3, 4 by about 2 metres but keep the shape.
3. In the thicket numbered 31, the sprawling shapeless yew on the right as you face the church should be removed along with the undergrowth
4. Remove the self-planted yew from no 27, leave the sycamore but reduce height. The holly and privet in this area should also be removed.
5. Remove oak no 1 by wall and road. This is a nice tree, but is totally mixed up with telephone wires, telegraph post, and lamp post, and is very close to the road and wall.
6. Remove pine no 32 by wall and road
7. Reduce height of 2 limes by path leading to school, nos. 24 and 26 on map. 24 should be reduced in height from the top, but without changing the shape of the tree. No 26 has been coppiced and this should be done again reducing all stems down to the ground.
8. Remove sycamore no 20 on map. This tree is diseased at the bottom where it splits.
9. Cedar no 18. This tree needs selective branch reduction, thinning and weight reduction on church side.
10. Remove no 14 acacia. It is half dead and near to cables.
11. The Norwegian maple which Holy Trinity School asked us to remove should not be cut down. It has not been responsible in any way for the state of the flint wall. The deterioration of the wall has been caused by a drain pipe installed by the school running off down the wall and dissolving the mortar. We will be asking the school to pay for the repair of the wall

Work required to trees in St Andrews Churchyard

This churchyard is not so overpopulated with trees, but the ones which are there need to be reduced in size.

1. Avenue leading from the top gate. Reduce height of all trees. Remove the first marked no 1 on map
2. Reduce beech by Colchester Road no 7 on map, where it hangs over the road. The branches on the road side should be 4 metres above ground level in the church yard
3. Remove sycamore by East window no 2, as it has fungal growth at the split and is threatening the East window
4. Shape and condense the yew by the edge of the churchyard overshadowing houses no 3
5. Remove straight yew near wilderness no 5
6. Remove tree near wilderness no 4 which has not regrown since pollarding. Check hollow trunk for bats
7. Reduce 2 limes slightly above previous pollarding by bottom entrance onto Parsonage street
8. Reduce pear/crabapple by lower entrance
9. Reduce yew in avenue and remove lower branches no 6 by about 3 metres

Reproduced from the Ordnance Survey map with the permission of the Controller of Her Majesty's Stationary Office © Crown Copyright 2000. Unauthorised reproduction infringes Crown Copyright and may lead to prosecution or civil proceedings.

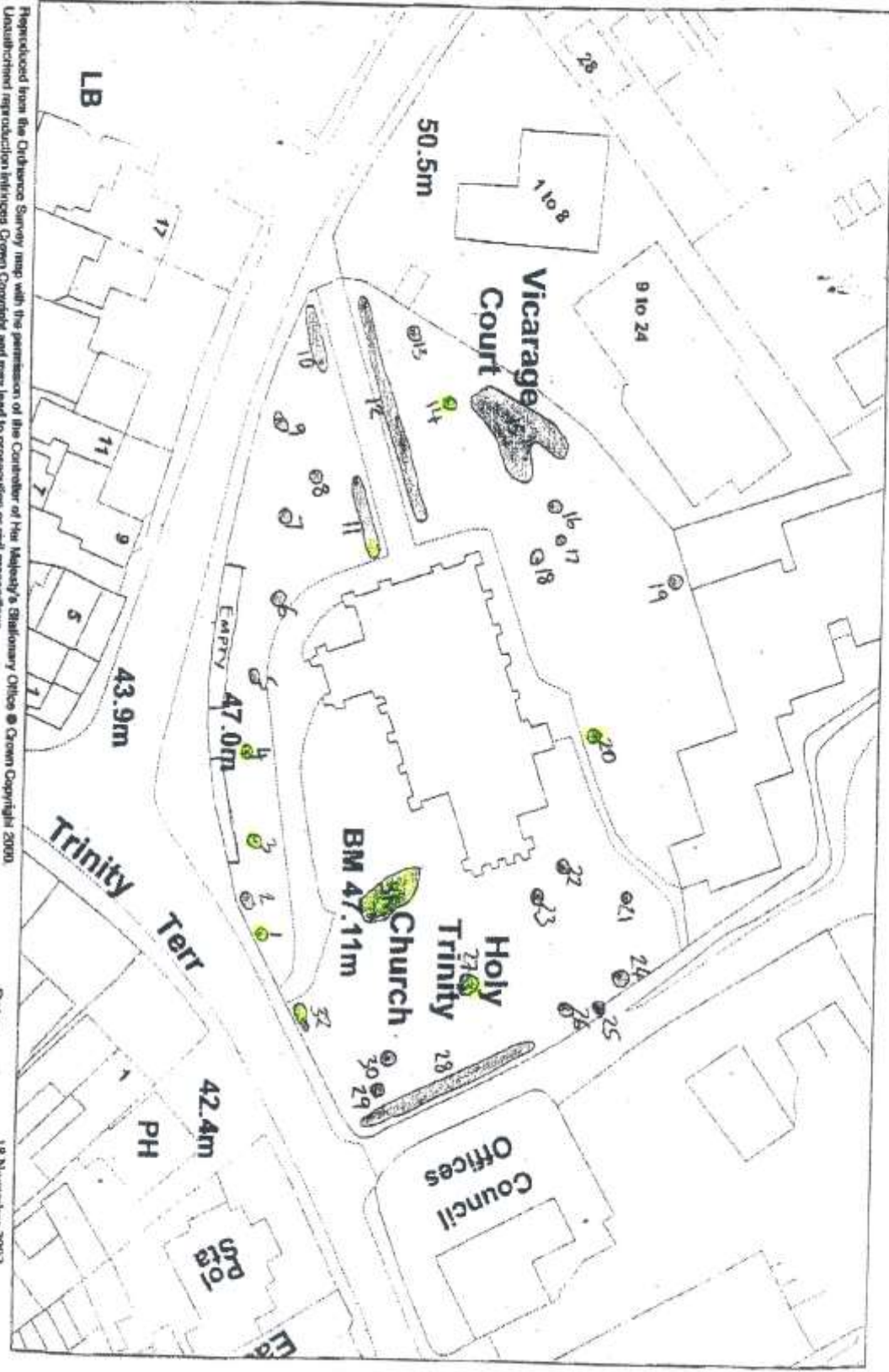

18 November 2003

ST ANDREW'S

↔ Z

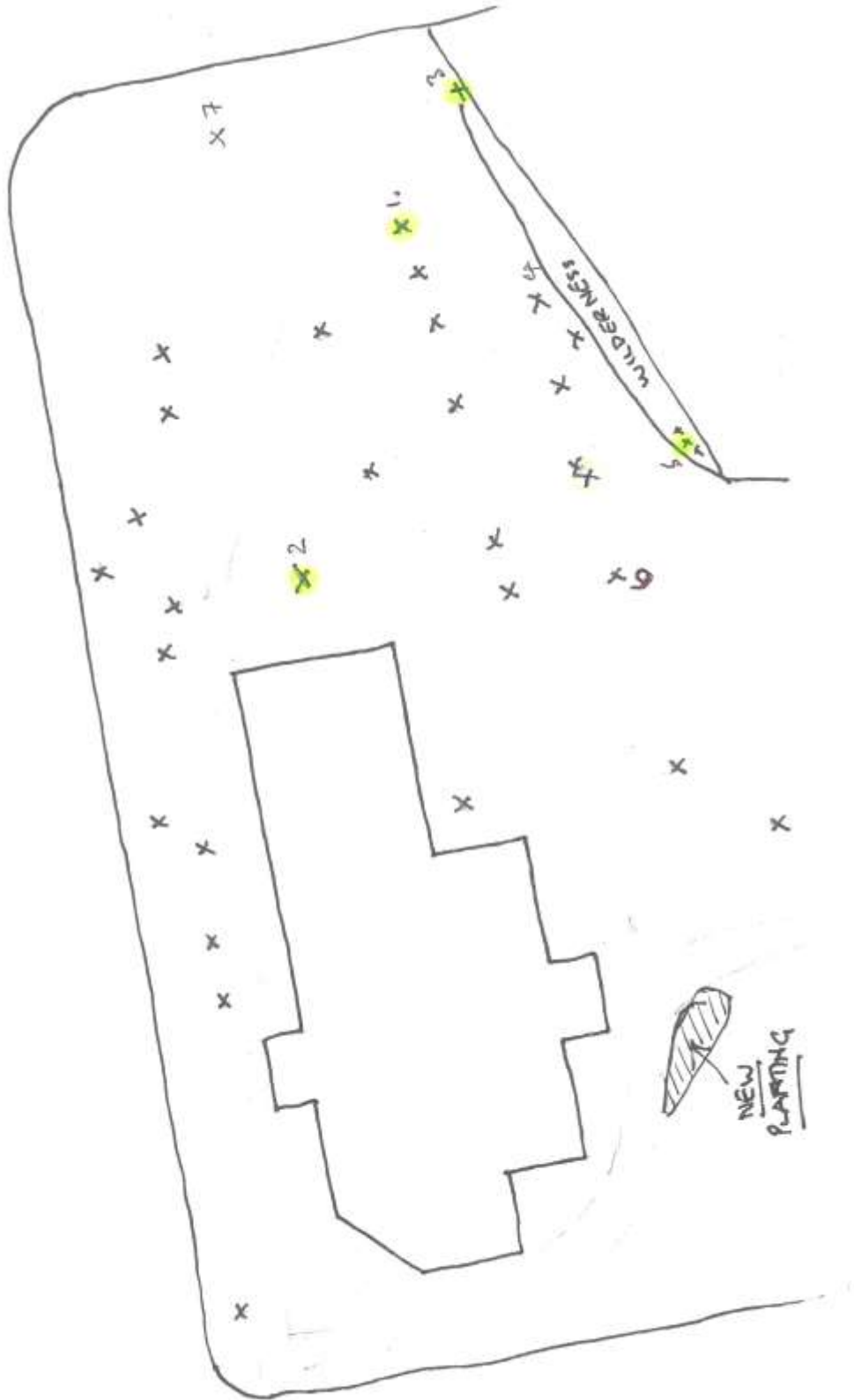

Summary

There is no provision in this year's budget or Earmarked Reserves for this work so the work would need to be considered as a priority as part of the budget process.

The work required can be categorised into two parts,

1. Maintenance work – this is work required to maintain the trees in good order

We have received quotations for this work and the total cost is in the region of £3,500. This should be included in the 2019/20 budget, and carried out at the earliest opportunity in that year.

2. Aesthetic work

This work is intended to improve the look of the churchyards and the churches, mainly removal of self-planted yews. This is currently costed at around £4,500. The Council should consider whether it should include this work in future budgets.

Financial provision for future long-term tree maintenance

Further tree maintenance will be required in future years and the Council should make provision in its Earmarked reserves for future costs. This should be considered as part of the next budget process.

Recommendation: that HTC notes this report and considers the expenditure as a priority at the budget seminar in December 2018.

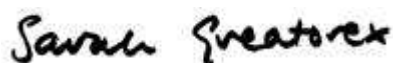

Sarah Greatorex Town Clerk